

PHILHARMONIC MUSIC HOUSE

MODULAR BUILDING OF THE PHILHARMONIC

Taking into account the use of modular technology for the construction of the building that will have the **South Czech Philharmonic**, the first challenge has to achieve to define as the materiality of the modules with the concert programme could join according to the standards of acoustic conditioning necessary for an auditorium with capacity for 1000 people.

Having this idea in the mind, it began the exploration and study of the emplacement and its surroundings as well as the **historical precedents** of the city of Ceske Budejovice.

The plans and satellite images account for the configuration of **walled city** that it possessed the historical core of the center of the city, condition confirmed with plans and images obtained in the process of investigation.

According these precedents, the current emplacement, the area of the **Mariánské náměstí** has part of the area that **serves as receiver** for the door of the north access, but it was not considered inside the configuration of the system of defense.

At present, the traces of the system of defense prevail in the configuration of a park that surrounds the old core of the city, Na Sadech park.

The block that forms the area of the emplacement presents a development and urban planning only in the north sector, leaving the area of the Mariánské náměstí **opened towards the park** that forms accent defense system and formed by the main avenues that connect with the center of Ceske Budejovice.

Thus, the first thing is the finish **configuring the northern edge** of the area establishing a limit between the consolidated neighborhood of new urban planning and the historical center of the city keeping the existing tension between the Mariánské náměstí and the great green zones of Na Sadech park.

For that, it is projected the construction of **a system of walls** that consolidate the north rim of the area using the configuration of the **modular system**, protecting the rest of the program and the main use; the room of concerts.

The volume that will contain the concerts hall will remain surrounded in two of its rims, north and east for the wall opening towards the historical center of the city and the main avenues that maintain a constant flow of vehicles and pedestrians.

Besides, it will establish a direct visual relation towards the park of the ancient system of defense to determine the form of the concert hall, the study of the big auditoriums of European cities was of great help to confirm that the typical form of the rectangular prism is the one that offers a better acoustic experience. It is therefore that the base for development of the concert hall takes as reference the disposition of the walls system in the area and by means of the modulation, it forms the rectangular prism that contains the concert hall, covered with a textile membrane, in order to create an urban landmark, a light box that embraces culture and music.

The wall constructed with modular technology will contain any complementary program to the concert hall; cloakroom for musicians, cloakroom for orchestra director, for the concert master, and cloakroom for the inspector. Distributed between the first and second level quite near to the common room with capacity for 80 people and enabled for the choir. This area will be connected by the hoist that directs at the level where it will be the main warehouse near to the stage.

In the central area of the modular wall, it locates the whole administrative program, maintenance and the central file.

In the south sector of the modular wall it locates the programs of public use; in the first level, a shop demanded by the program and the sanitary facilities for the visitors.

In the second level, it locates a restaurant with view to the park, to the outdoor stage and to the immediate environment of the new building.



Mariánské náměstí, relation with old defense system and the Historic core of the City

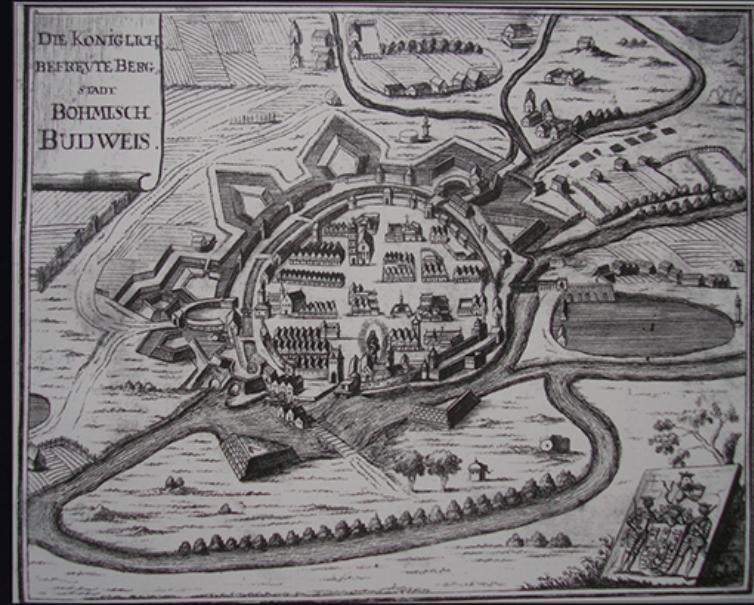

Ceske Budejovice historic plan, shows walled city system with the north access at left side in picture. The Mariánské náměstí is not included on defense system.

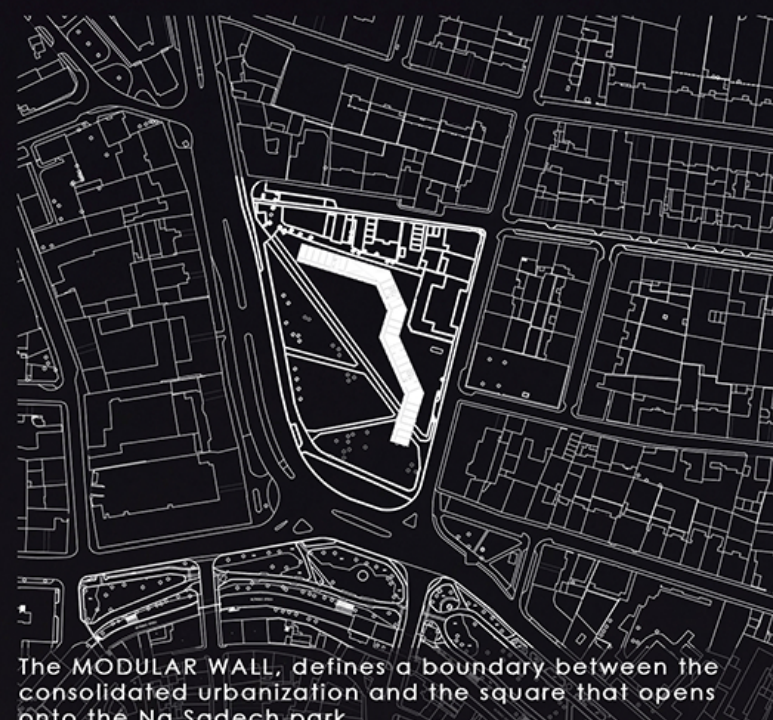

The MODULAR WALL, defines a boundary between the consolidated urbanization and the square that opens onto the Na Sadech park.

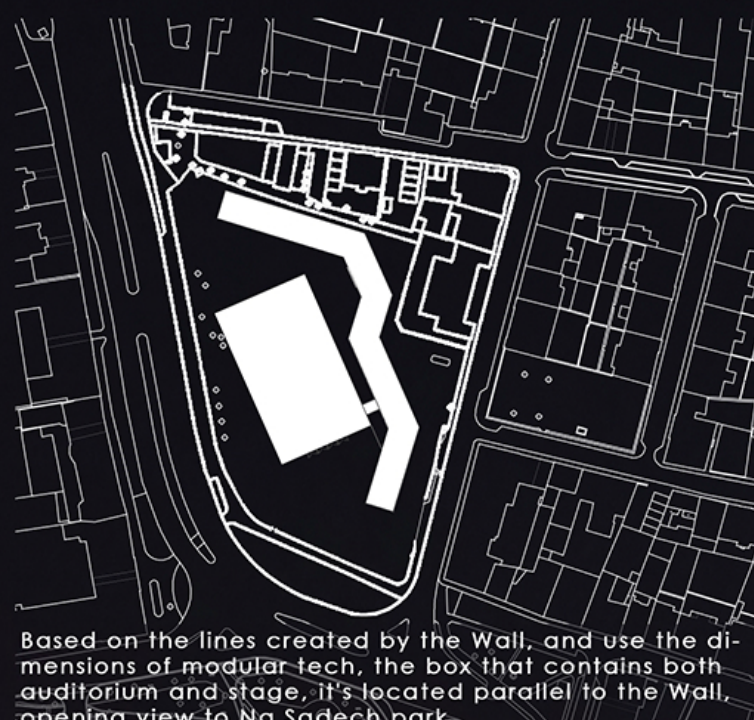

Based on the lines created by the Wall, and use the dimensions of modular tech, the box that contains both auditorium and stage. It's located parallel to the Wall, opening view to Na Sadech park.

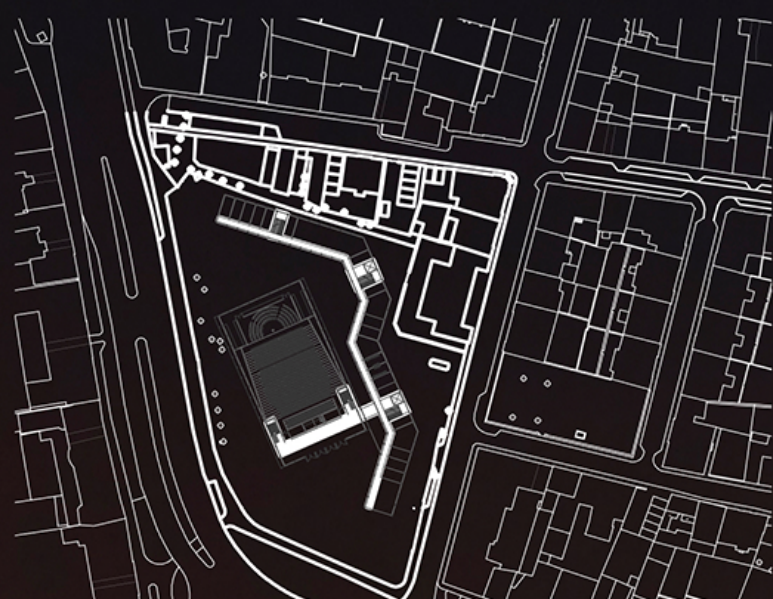

The modular technology used in the proposal is the modulus of the Koma Standard line, to take advantage of its extensive dimensions in the design of spaces for use by several persons.

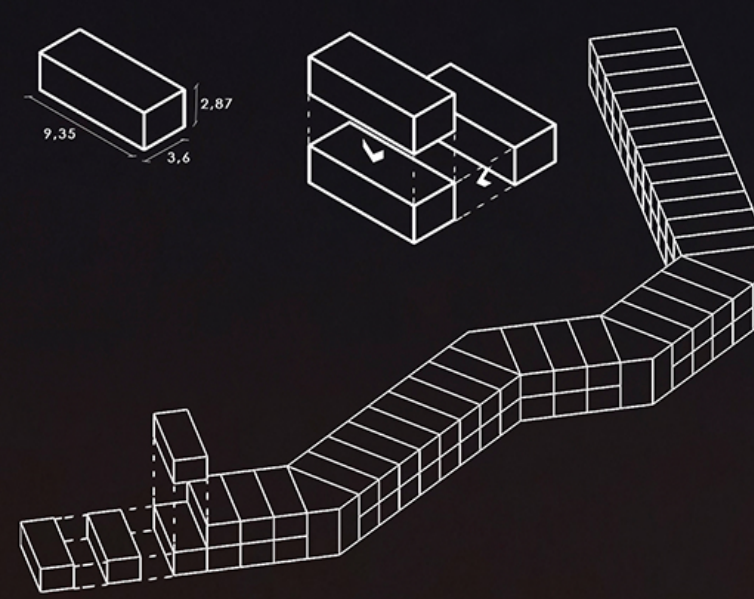

The modular technology used in the proposal is the modulus of the Koma Standard line, to take advantage of its extensive dimensions in the design of spaces for use by several persons.

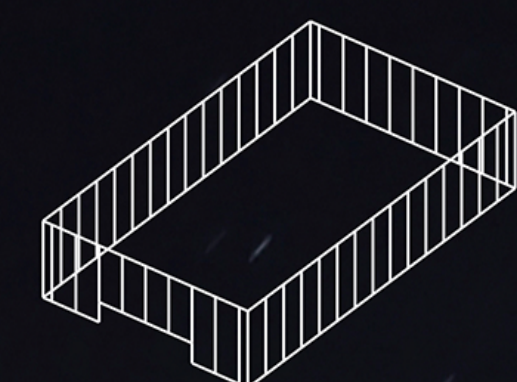

PVC cover textile membrane surrounds the building, providing lighting qualities that make him a reference on the city

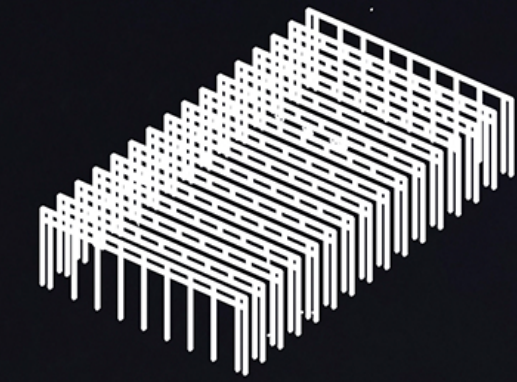

Modulated structure steel according modular technology dimensions

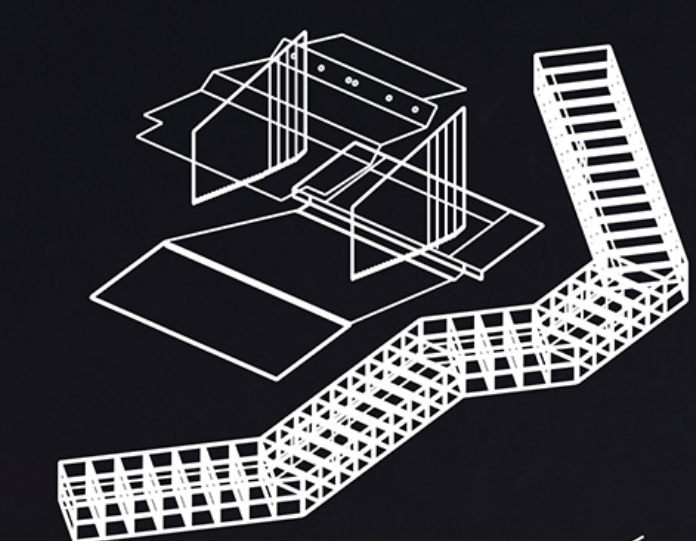

"Modular wall" system
Acoustic conditioned walls of auditorium

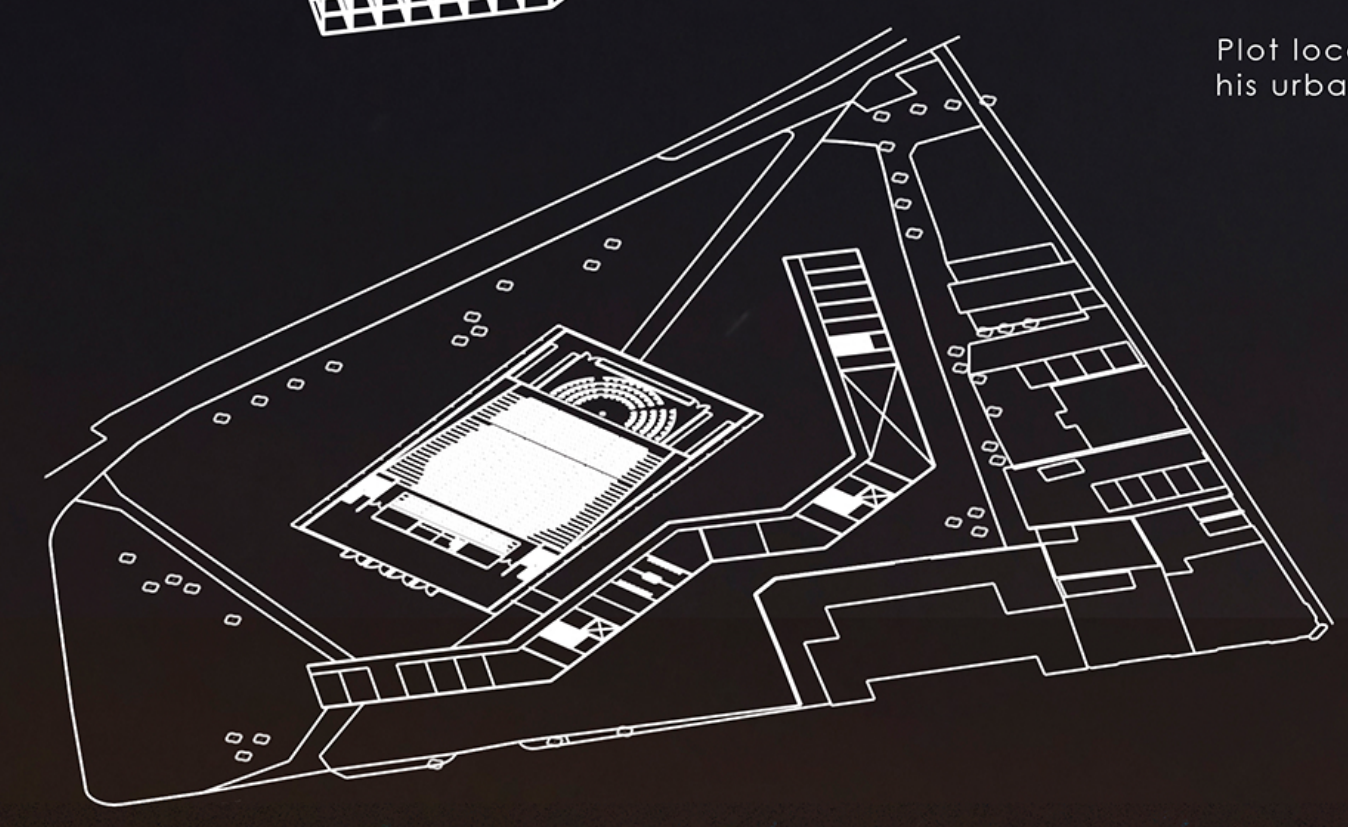

Plot location and his urban context



PLANIMETRIC INFORMATION

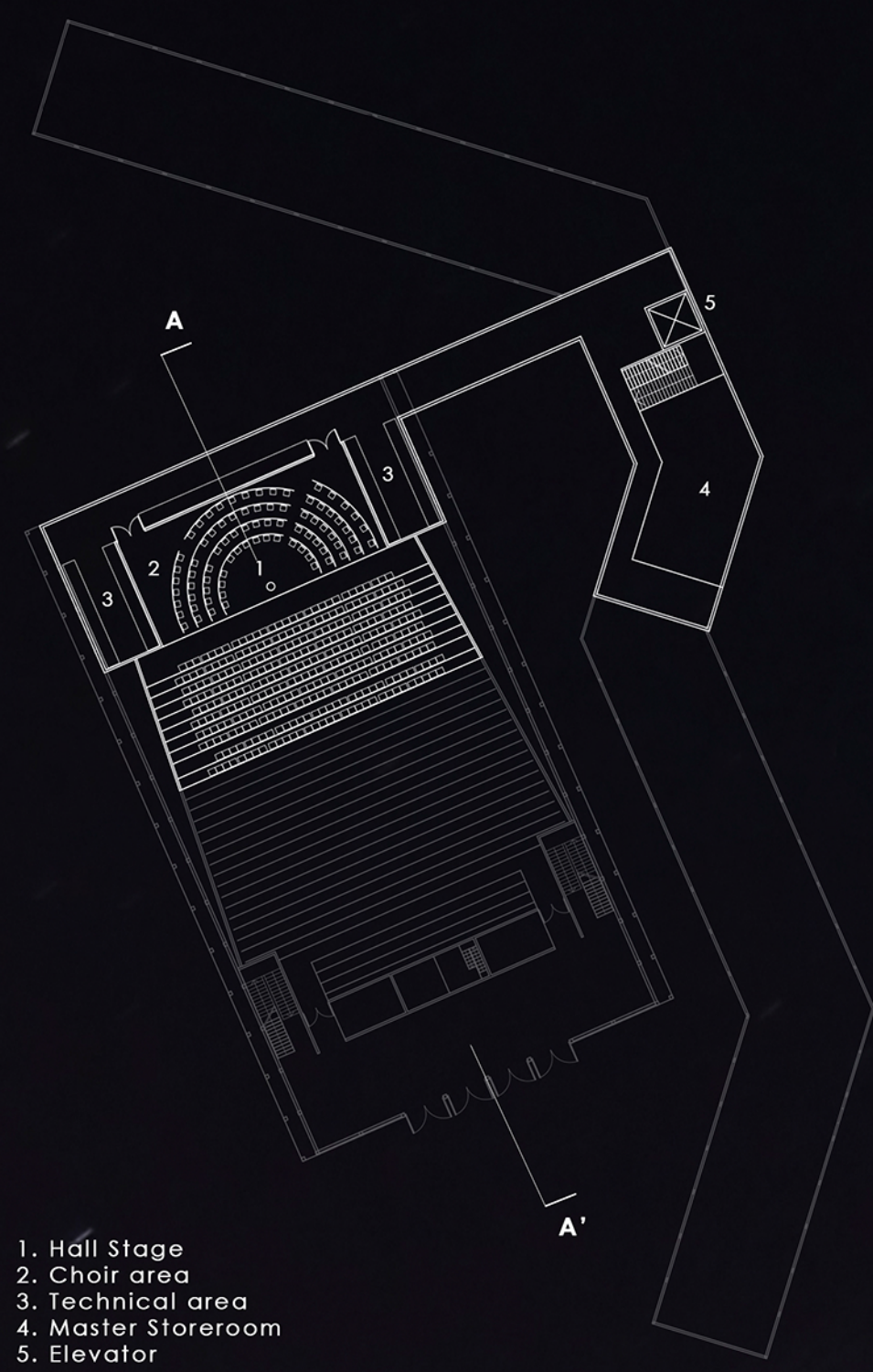

- 1. Hall Stage
- 2. Choir area
- 3. Technical area
- 4. Master Storeroom
- 5. Elevator

Level floor -5,7m 1/500

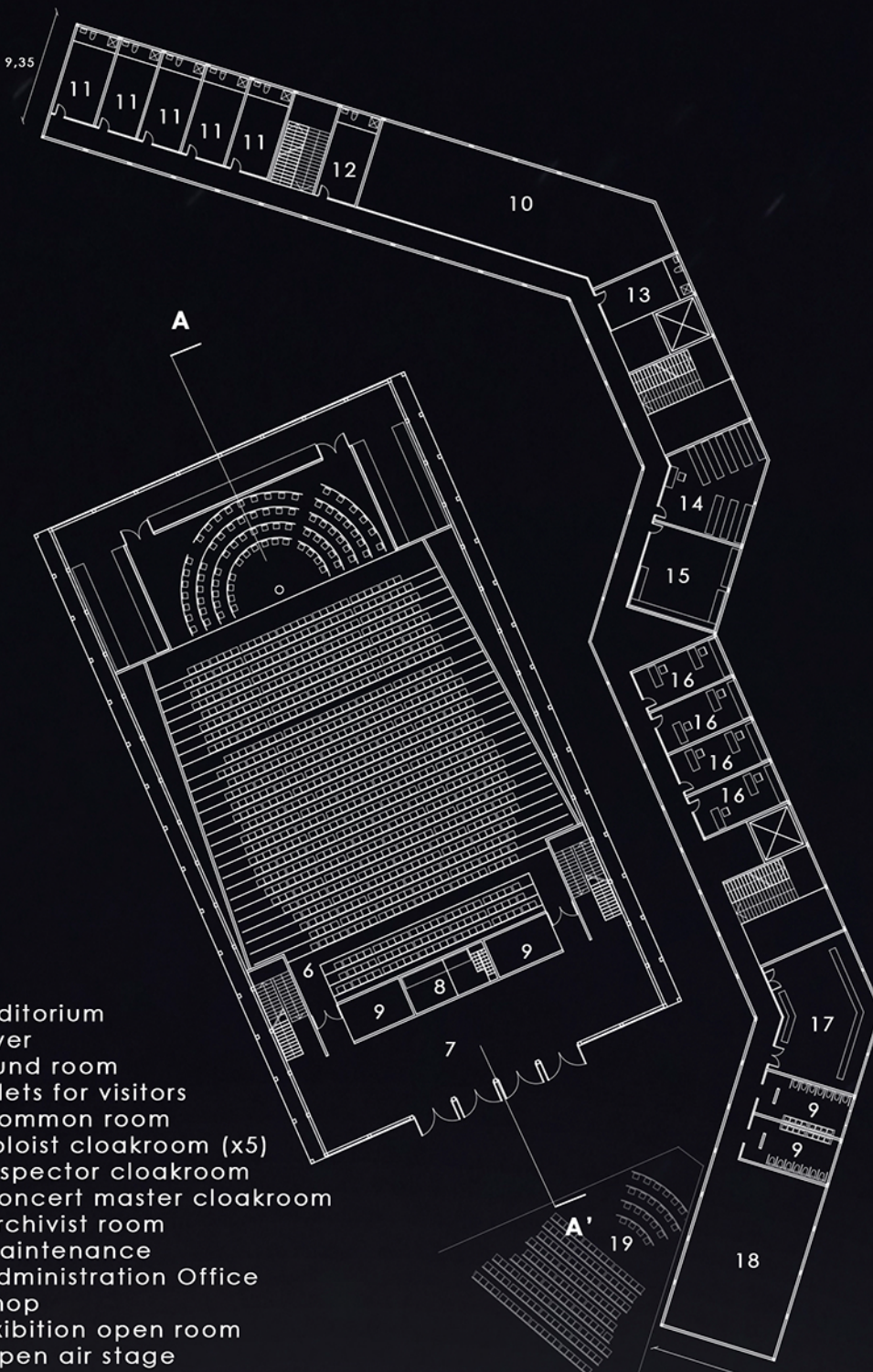

- 6. Auditorium
- 7. Foyer
- 8. Sound room
- 9. Toilets for visitors
- 10. Common room
- 11. Soloist cloakroom (x5)
- 12. Inspector cloakroom
- 13. Concert master cloakroom
- 14. Archivist room
- 15. Maintenance
- 16. Administration Office
- 17. Shop
- 18. Exhibition open room
- 19. Open air stage

Access floor ±0,0 m 1/500

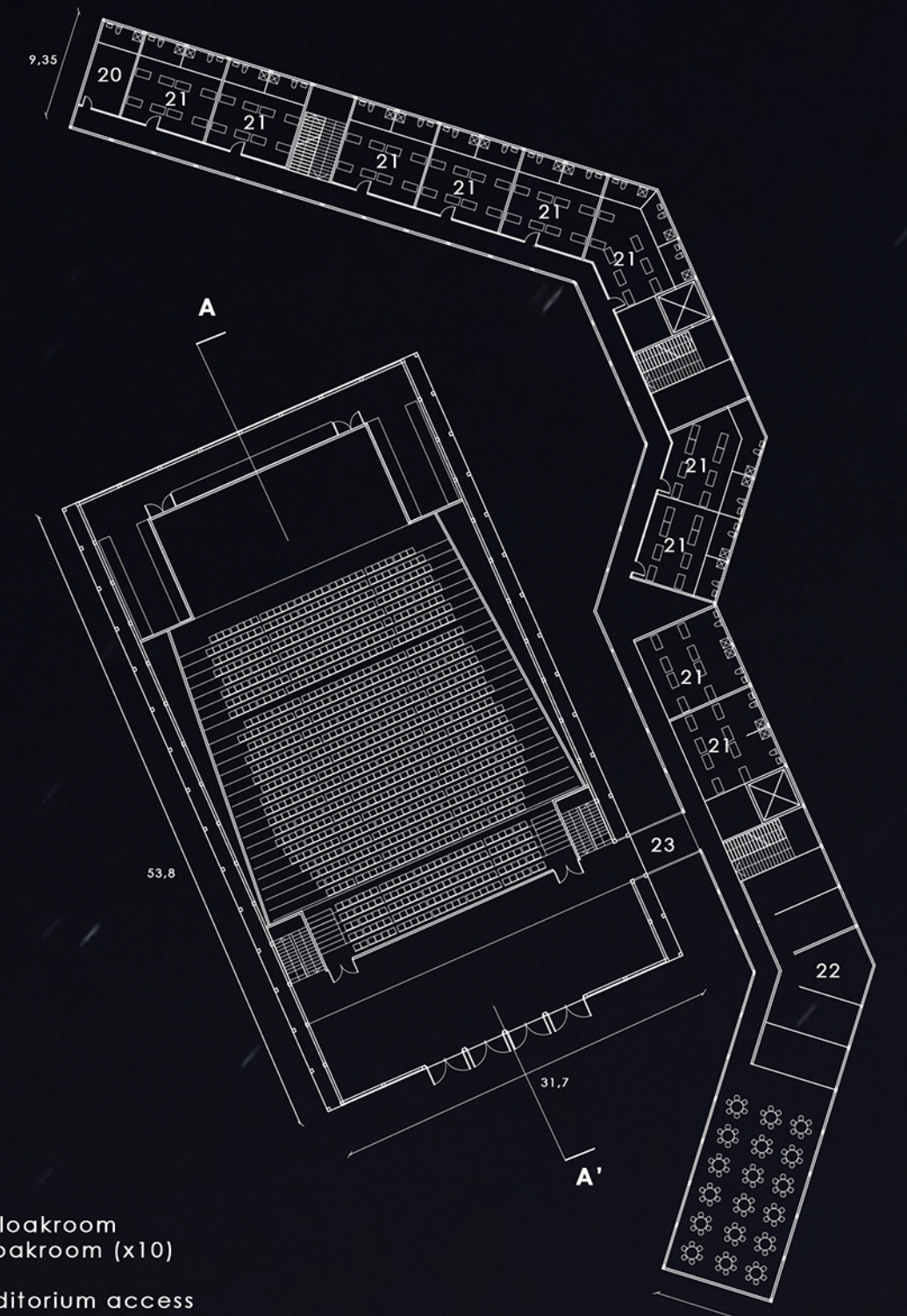

- 20. Conductor cloakroom
- 21. Musicians cloakroom (x10)
- 22. Restaurant
- 23. 2nd floor auditorium access

Level floor +5,7 m 1/500

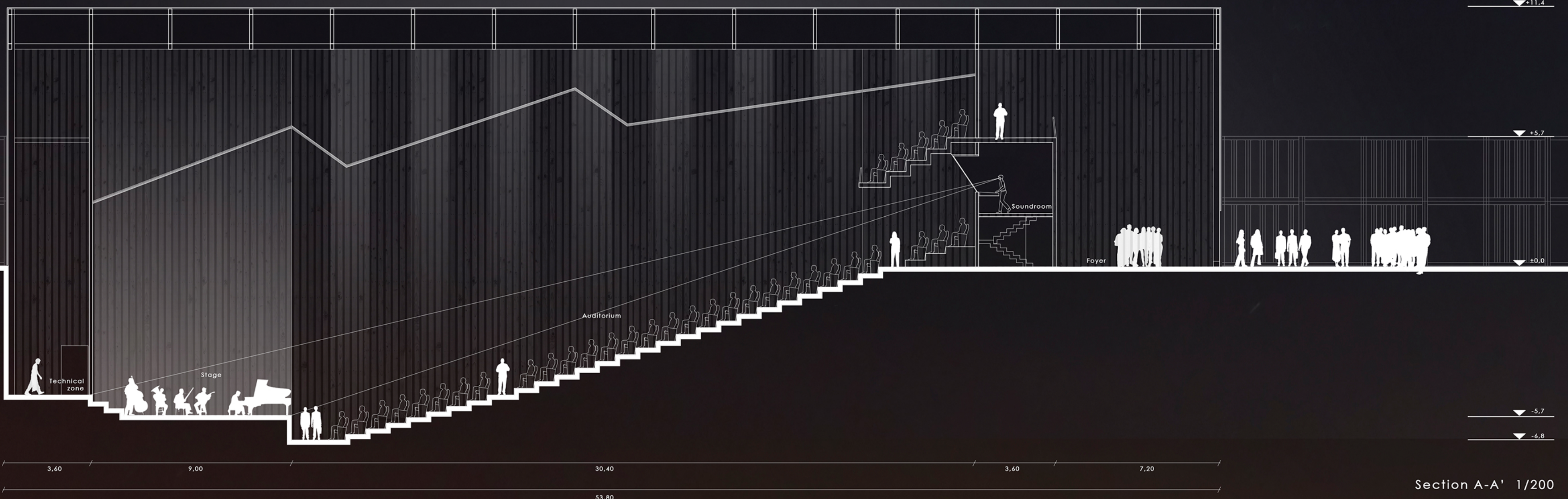

Section A-A' 1/200

MAIN AUDITORIUM VIEW

